

Revision	01	Description	First	Date	2023.02.25	Signed	YP
----------	----	-------------	-------	------	------------	--------	----

Pin	Pin Name
1	BL-K
2	BL-A
3	GND
4	VDD
5	LOWCC
6	TE
7	CS
8	RESET
9	RS
10	WR
11	RD
12	DB7
13	DB6
14	DB5
15	DB4
16	DB3
17	DB2
18	DB1
19	DB0
20	GND

背光正极: PIN2
背光负极: PIN1

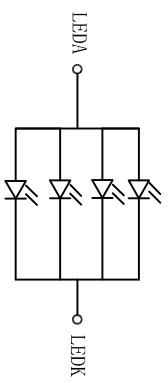
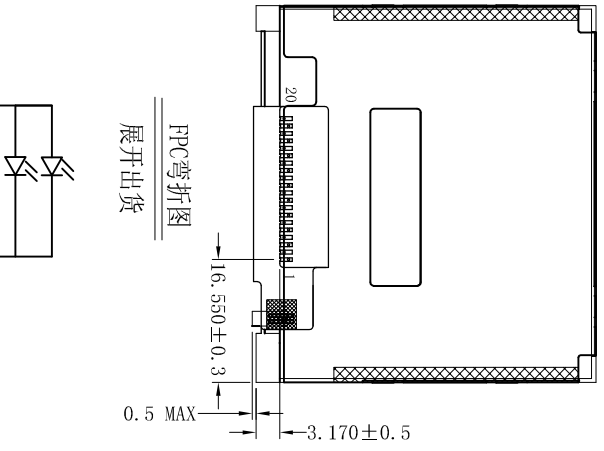
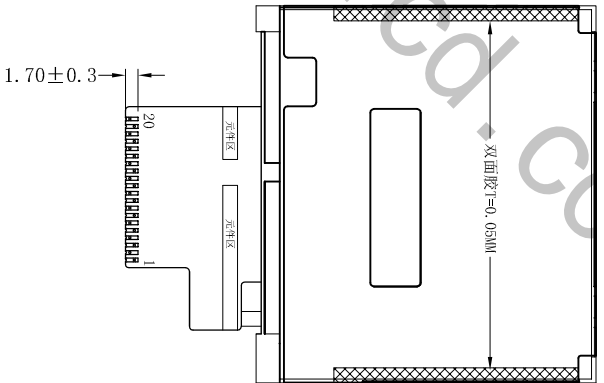
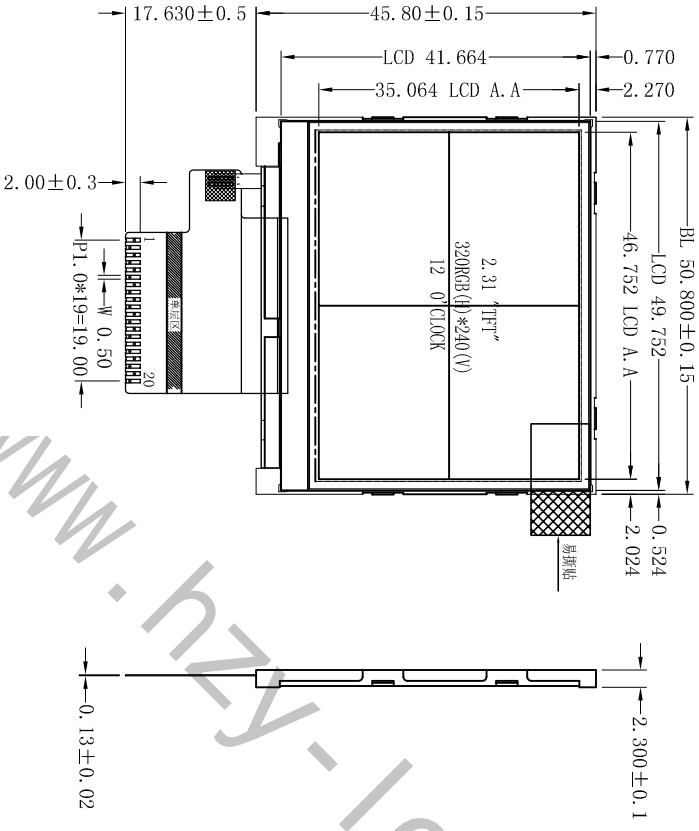

电路图 V=3.2V, I=20*4=80mA

PPC弯折图
展开出货

- NOTES:
1. DISPLAY TYPE: 2.31" TFT, TRANSMISSIVE
 2. DRIVER IC: ILI9342C
 3. VIEWING DIRECTION: 12 O'CLOCK
 4. BACKLIGHT: 4 pcs White LED
 5. INPUT CURRENT: VCC 2.8V (type)
 6. OPERATING TEMP: -20° C ~ +70° C
 7. STORAGE TEMP: -30° C ~ +80° C
 8. UNDEFINED DIMENSION TOLERANCE: ±0.2mm
 9. RoHS COMPLIABLE

深圳市华之洋光电科技有限公司
Shenzhen HZY Photoelectric Technology Co., Ltd

Customer Ref.	Model No.	Drawing Title	HZ231QTHY01-A0	
Part No.	Approve	Material	Unmarked Tolerance	Unit
Drawing No.	Checked	LCM	±0.2	mm
---	Draw	YP	Date	2023.02.25
---	---	---	Rev	00